

# EESWOOD

## UC25N

**Installation and  
Operation Manual**

**MODEL: UC25N UNDERCOUNTER DISHWASHER**



[www.middleby.com.au](http://www.middleby.com.au)

 **MIDDLEBY AUSTRALIA**

---

## **MANUFACTURER**

Goldstein Eswood Commercial Cooking PTY LTD

---

For inquiries please call your nearest state branch or visit our website

---

### **NSW**

211-217 Woodpark Road  
Smithfield NSW 2164

---

### **VIC – TAS**

47 Stubbs Street  
Kensington VIC 3031

---

### **QLD**

U12, 210 Queensport Rd Nth  
Murarrie QLD 4172

---

### **WA**

U2, 9 Meares Way  
Canning Vale WA 6155  
08 9456 0559

---

1800 013 123 | +61 2 9604 7333

---

### **SALES & ENQUIRIES**

Sales: [sales@middleby.com.au](mailto:sales@middleby.com.au)

Parts Enquiries: [spares@middleby.com.au](mailto:spares@middleby.com.au)

Technical Enquiries: [technical@middleby.com.au](mailto:technical@middleby.com.au)

**[www.middleby.com.au](http://www.middleby.com.au)**



**1. Contents**

1. CONTENTS..... 3

2. INTRODUCTION ..... 4

3. SPECIFICATIONS..... 4

4. DIMENSIONS..... 5

5. INSTALLATION ..... 6

6. OPERATION ..... 8

7. CLEANING AND MAINTENANCE ..... 9

8. TROUBLE-SHOOTING..... 10

9. WIRING DIAGRAM ..... 11

10. SPARE PARTS ..... 12

11. WARRANTY ..... 14

**1.1 Safety Notice**

The below symbols may be used in isolation or combination throughout this manual. Where used, these symbols are intended to alert personnel of potential risk, either to themselves or to the equipment and/ or convey important messages regarding the safe operation and maintenance of the appliance.



**CAUTION**

**This appliance is intended for professional use and is only to be used by trained, qualified personnel. Installation, maintenance and repairs should be performed by an authorized Goldstein Eswood service agent or qualified personnel. Installation, maintenance or repairs by an unauthorized and unqualified personnel will void the warranty.**



**WARNING**

**This appliance contains dangerous voltages and can be hazardous. Improper installation, adjustment, alteration, service or maintenance can cause property damage, injury or death. Please read the installation, operating and maintenance instructions thoroughly before installing or servicing this appliance.**



**ATTENTION**

**All plumbing and electrical work must be installed as per manufacturer’s instructions, the Plumbing Code of Australia, AS3000 – Wiring Rules, AS1668.2 – Mechanical ventilation in buildings and any other local regulations.**

## Specifications

---

### 2. Introduction

Congratulations on purchasing your Eswood commercial dishwasher. Goldstein Eswood Commercial Cooking is an Australian company and has been operating since 1911, building high quality products.

The information contained in this manual will assist your installer and ensure correct location and connection. Thoroughly read the operation instructions and the maintenance sections, as understanding your products, its operation, and its cleaning and service requirements will provide you with long and satisfactory service. Neglecting regular cleaning and maintenance could shorten the life of the product and decrease its efficiency. Please ensure only authorised service technicians are called to any difficulties that may arise.

### 3. Specifications

#### 3.1 General Machine Specifications

<b>Net Weight</b>	68kg
<b>Hourly Capacity</b>	400 x Ø305 dinner plates / hr
<b>Wash Cycle Time</b>	3 cycles: 60s/ 90s/ 120s
<b>Dwell / Rinse Cycles</b>	4s / 15s
<b>Standard Equipment</b>	500 x 500 racks: 1 plate basket, 1 cup basket & 2 cutlery baskets
<b>Drain Outlet</b>	Ø22mm x 1.8m drain pump hose
<b>Detergent Injector</b>	0 – 8.5mL (adjustable)
<b>Rinse Aid Injector</b>	0 – 8.5mL (adjustable)

#### 3.2 Wash Power Specifications

<b>Wash Tank Capacity</b>	17L
<b>Wash Tank Power</b>	550W
<b>Wash Pump Capacity</b>	280L/min
<b>Wash Tank Heater</b>	500W
<b>Wash Temperature</b>	60°C - 65°C

#### 3.3 Rinse Power Specifications

<b>Rinse Tank Capacity</b>	7L
<b>Rinse Tank Heater</b>	2400W
<b>Rinse Temperature</b>	82° - 85°C
<b>Water Consumption</b>	3.5L

#### 3.4 Electrical and Water Specifications

<b>Electrical Input Socket</b>	240V 50Hz 15A Single Phase
<b>Electrical Load</b>	3.45 kW
<b>Hot Water Inlet Temp</b>	65°C Minimum
<b>Inlet Pressure</b>	200 – 400 kPa
<b>Hot Water Connection</b>	¾" BSP
<b>Water Hardness</b>	<100 ppm
<b>Drain Outlet</b>	Ø22mm x 1.8m hose

**Note:** Inlet water quality must be potable. Do not use bore water without suitable filtration systems. Soften or filtrate inlet water in excess of 100 ppm and descale as necessary. Fit a pressure reducing device for pressure over 400 kPa.

4. Dimensions

4.1 UC25N

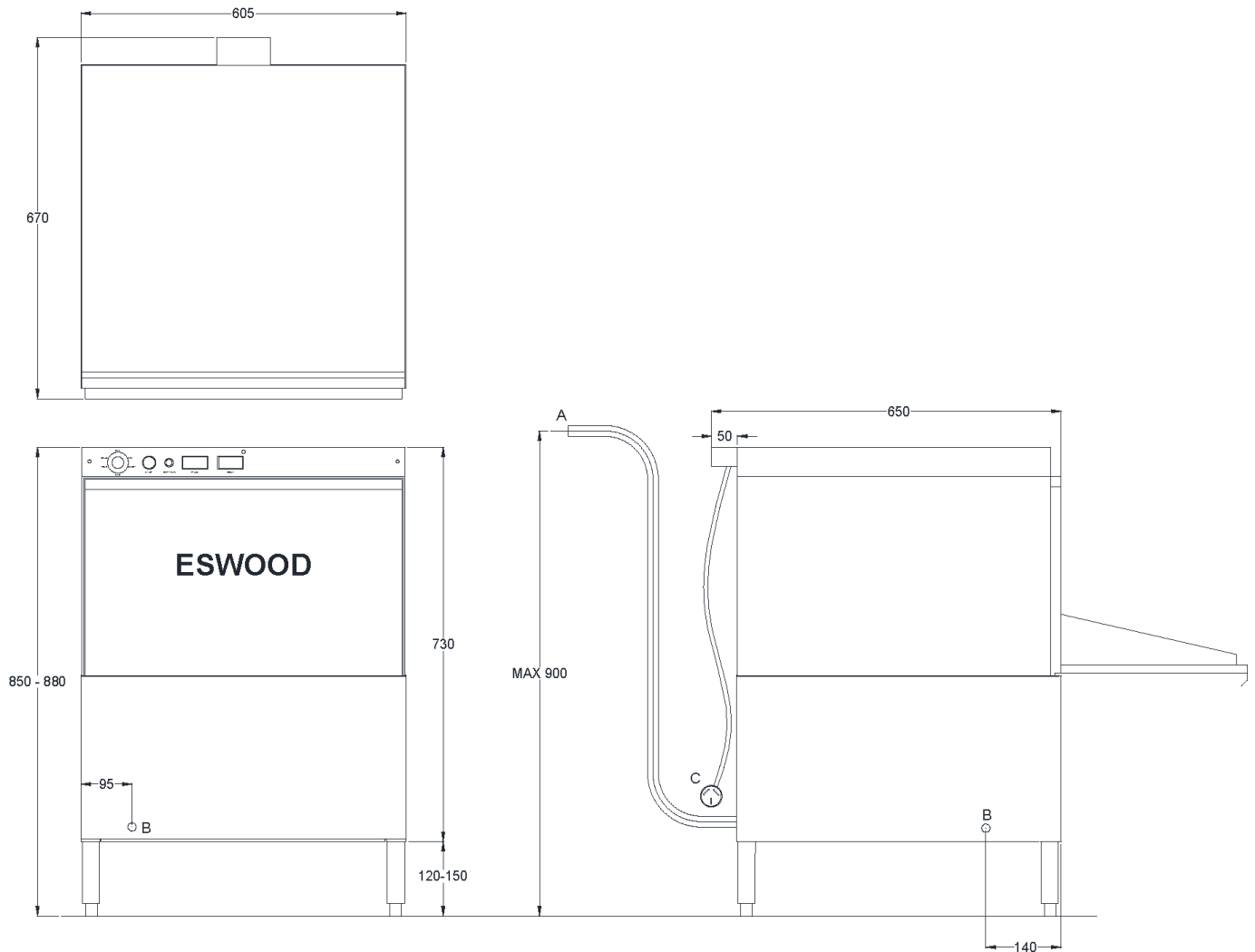

- A. Drain - Ø22mm x 1.8m flexible drain discharge hose.
- B. Hot Water Supply - 3/4" BSP x 1.5m hose supplied.
- C. Power cord - 2m
- D. Detergent hose & filter - 2m
- E. Rinse aid hose & filter - 2m

**Note: Dimensions may change without notice in accordance with product design and development**

### 5. Installation

Eswood dishwashers are designed to give long and satisfactory service and incorporate the best possible materials and workmanship. Proper installation and preventative maintenance are vital for optimum performance and efficiency.

 **WARNING**

**This appliance must be installed by qualified personnel and in accordance with manufacturer's instructions, AS/NZS3500.1 and any other local codes & regulations. Installation, maintenance or repairs by unauthorized and unqualified personnel will void warranty.**

#### 5.1 Receiving Inspection & Unpacking

- Remove carton, packaging and all plastic protective material from the appliance.
- Check for damages to the appliance and report any damage to the transport company and dealer.
- Ensure all loose packaged items i.e. baskets, hoses & warranty cards are provided with the unit and report any missing items.
- Check the rating plate corresponds with the available electrical supply.

#### 5.2 Installing into Location, Water and Electrical Connections

- Remove the lower panel, position the machine and level by screwing the adjustable feet.
- Connect the  $\varnothing 22$ mm drain hose to a drain trap spigot or alternative drain discharge line.
- Connect the hot water supply hose to the dual check valve and then connect to a  $\frac{3}{4}$ " BSP isolating valve adjacent to the machine.
- Ensure that the rotary switch on the control panel is OFF and the toggle switch behind the lower panel is set to the INSTALL position. Connect the three-pin plug to a 15A, 240V, 50Hz, power outlet.
- Place the detergent and rinse aid tubes and filters into their respective bottles.



 **ATTENTION**

**Do not make water or plumbing connections that will prevent the machine from being removed from its installed position for servicing purposes.**

### 5.3 Commissioning and Initial Start-Up Procedure

Once the appliance has been installed always ensure its functions are operating as per the following check list. Refer to Operation in section 6 for further details on how to operate each control.

1. With the rotary switch on the control panel OFF turn the water and power on.
2. Ensure all parts are in their correct positions i.e. the overflow tube is placed into the wash tank drain and the intake filter is located over the pump suction hole then close the door.
3. The machine is fitted with automatic detergent and rinse aid injectors. Place the filter ends of the tube into a bottle of suitable machine dishwashing detergent and rinse aid. The injectors must not run without detergent and will prime itself after the initial cycles. Use only quality, commercial dishwashing and rinse aid product or contact Goldstein Eswood to order the recommended detergent and rinse aid.



4. Turn the rotary switch to the FILL position, close the door and press START, the rinse cylinder will begin to fill with water and the START light will flash until the cycle is complete. When the rinse cylinder is full, water will flow out of the rinse jets, fill the wash tank and stop automatically. The START light will stop flashing and remain on when the fill cycle is complete.

 **ATTENTION**

**It is vital that all air is expelled from the rinse cylinder and the heating elements are safely covered with water. Damage to the elements is not covered under warranty if the rinse tank has been improperly filled.**

5. Open the door and check the water level in the wash tank is within 30mm of the overflow level. Place all the strainers into position in the wash tank, close the door and flick the toggle switch behind the lower front panel to the OPERATE position.  
**NOTE: After flicking the toggle switch to the OPERATE position the unit must reach at least 78°C before filling or washing can start.**
6. Turn the rotary switch to a CYCLE (i.e. short, medium or long) position and press the START button. The machine will not start until the water in the rinse cylinder has reached 78°C, as indicated by the LOW TEMP. indicator light. At this temperature or above, the machine will start and stop automatically as indicated by the flashing START light. When the cycle is complete the START light will remain alight unless the door is open.
7. Check under the machine for leaks and any loose items. Check that the upper and lower wash arms turn freely and check that all indicator lights are functioning correctly.
8. At the end of the cycle, turn the rotary switch to the OFF position, open the door, remove the strainers and remove the overflow tube to drain the tank.  
Close the door and select DRAIN on the rotary switch then hold the START button for 3 seconds until the light flashes. This activates the drain pump and empties the wash tank. Place the overflow tube and strainers back into position once the tank is empty.
9. Refit the lower front panel and open the door to air out the machine.

## Operation

### 6. Operation

#### 6.1 Washing Operation

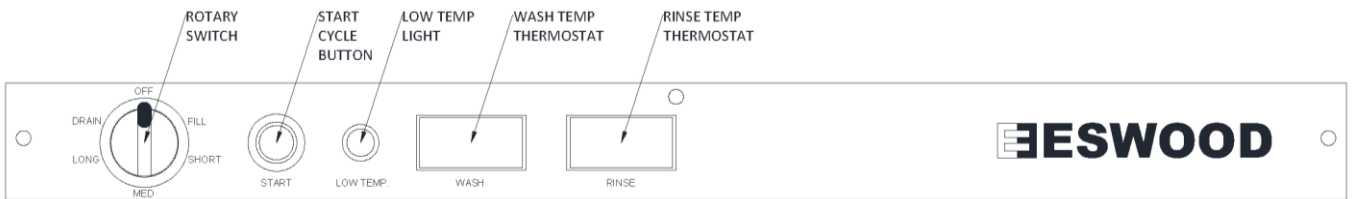

#### UC25N Control Panel

1. Turn the rotary switch to the fill position and allow the rinse temperature to heat up to at least 78°C. Ensure the pump intake filter is clean and in place over the pump intake hole and the overflow tube is placed into the drain.
2. When the unit has reached temperature, close the door and press the START button. The START button will flash until filling is complete.
3. When the machine has finished filling, open the door and check that the water is up to the overflow level. The wash tank heating is actuated automatically. Place the strainer trays in place within the tank.
4. Select one of three auto cycles on the rotary switch per the degree of soiling on the glass or dishware. Use a short cycle for light soiling and a long cycle for heavy soiling.
5. Scrape or spray off any loose food matter and place the dirty items in an appropriate rack. Open the door, slide the rack into the machine, close the door and press the START button. The START light flashes during the cycle until complete.  
Note: The cycle will not begin until the water in the rinse has reached 78°C to ensure sanitation and the warning light LOW TEMP will illuminate if the temperature is low. When loading racks, face the flat plates with face angled upwards, bowls can be angled forward and small items such as glasses and cups to be placed upside down in the open rack. To avoid breakages when washing stem-ware, it is advisable to use compartmented glass rack. Your supplier can advise you on the selection of an appropriate rack.
6. When the washing is finished, open the door and remove the clean rack. Repeat step 5 to wash another rack.

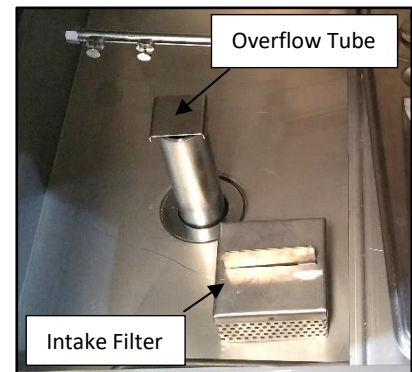

#### Key

Start light flashing:  
Start light on:  
Start light off:  
Low temp light on:  
Low temp light off:

#### Indication

a cycle is running.  
a cycle is ready to be selected.  
no power or door is open.  
rinse temperature is low and heating to 78°C.  
a cycle is ready to be selected.

#### ATTENTION

**This appliance is intended for professional use and is only to be used by trained, qualified personnel. Installation and repairs should be performed by an authorized Goldstein service agent or qualified personnel. Repairs by unqualified personnel will void warranty.**



### 7. Cleaning and Maintenance

#### 7.1 Shutdown & Maintenance

1. Turn the rotary switch to the DRAIN position. Remove and clean the strainer trays and overflow tube then close the door.
2. Press and hold the START button for 3 seconds until the light starts to flash. The start light will remain on when the drain cycle is complete. Turn the rotary switch to the OFF position. Once water has been drained from the wash tank, remove and clean the pump intake filter.
3. Refit the intake filter and overflow tube.
4. Check the rinse and wash arm jets are free of foreign matter. The arms can be removed by undoing the centre holding screw and then cleaned using a paperclip or picking tool under running water. Refit the arms back onto the shaft.
5. Clean the exterior of the machine with a damp sponge. Do not pass water over the electrical controls and avoid using abrasives or strong detergents.
6. Check for leaks and ensure that the arms rotate freely.
7. Leave the door open to allow the machine to air.

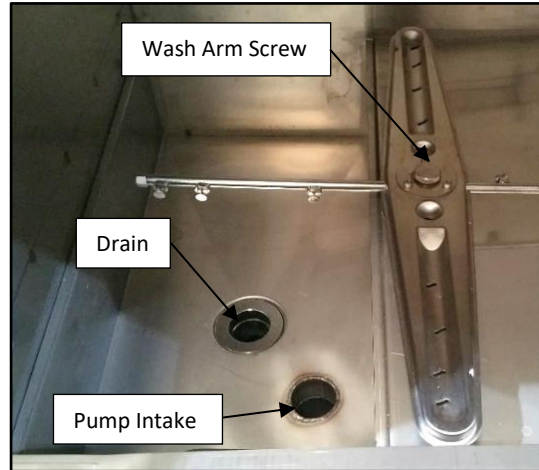

#### ATTENTION

**Never use wash hoses or water jets on this appliance. The appliance is not waterproof and caution is advised when hosing down floors near this appliance. Appliance electrical connections are commonly connected near the bottom of the appliance and water in this area can create hazardous conditions.**

#### 7.3 Periodic Maintenance

Incorporating a regular maintenance schedule will optimise and keep services running efficiently. Goldstein can provide an MIS (Machine Inspection Service) that delivers regular inspection and maintenance to reduce problems before they occur. For more information or to setup an MIS, please contact the nearest Goldstein branch.

#### CAUTION

**This appliance is intended for professional use and is only to be used by trained, qualified personnel. Installation, maintenance and repairs should be performed by an authorized Goldstein service agent or other qualified personnel. Installation, maintenance or repairs by an unauthorized and unqualified personnel will void the warranty.**

## Trouble-Shooting

### 8. Trouble-Shooting

Please refer to the following guide as reference to diagnose and repair some of the more common problems encountered. Should a problem not listed arise or in doubt, please contact Goldstein Eswood or an authorised service agent.

Fault	Cause	Solution
-Thermostats and lights not coming on.	-No Power.	-Check the isolating switch is turned on and fuses are okay.
-Machine will not start.	-Low rinse temp. -Door open. -Door switch not triggered or faulty.	-Check the rinse temperature has reached at least 78°C. -Check the door is closed properly. -Check the door switch is being triggered and replace if faulty.
Machine not filling correctly and/ or filling continuously.	-Restricted or no water flow. -Wash tank water leaking into drain. -Blocked or damaged solenoid valve. -Overfilling.	-Check the water isolating valve is fully open and check for obstructions in the water supply line. -Check if overflow pipe is seated correctly in the wash tank and check for foreign matter under the O-ring of the pipe. -Check for obstruction in the water supply solenoid valve and clean if necessary. Check diaphragm and replace if punctured. -Check the drain pump is operating. -Check for blocks in the drain hose and ensure there are no kinks in the hose to the outlet.
Poor wash.	-Low or no detergent.  -Blocked wash arms. -Incorrect placement. -Low wash temp, faulty elements or thermostat. -Faulty wash pump.	-Check the detergent feeder to machine is operating correctly and no air is in the tube. -Check for foreign matter in wash arm jets and clean. -Check the items to be washed are correctly placed in racks. -Check the wash temperature. If incorrect check thermostat settings and heating element operation. -Check the wash pump is functioning.
Poor rinse.	-Low water inlet pressure. -Blocked or restricted wash arms. -Blocked or damaged solenoid valve.	-Check water pressure to machine is not less than 200kPa and ensure the isolating valve is fully open. -Check rinse jets for foreign matter and clean.  -Check water supply solenoid valve is functioning correctly.
Insufficient rinse temperature	-Low water inlet temp. -Incorrect or faulty thermostat. -Elements damaged.	-Check the temperature of inlet water supply is at least 65°C. -Check rinse tank thermostat is set correctly and functioning.  -Check rinse tank elements are operating correctly.
SERR on thermostats	-Sensor probe error	-Check the thermostats are set for the correct probe type. -Check the temperature sensor probes for damage and replace if necessary.

9. Wiring Diagram

9.1 UC25N

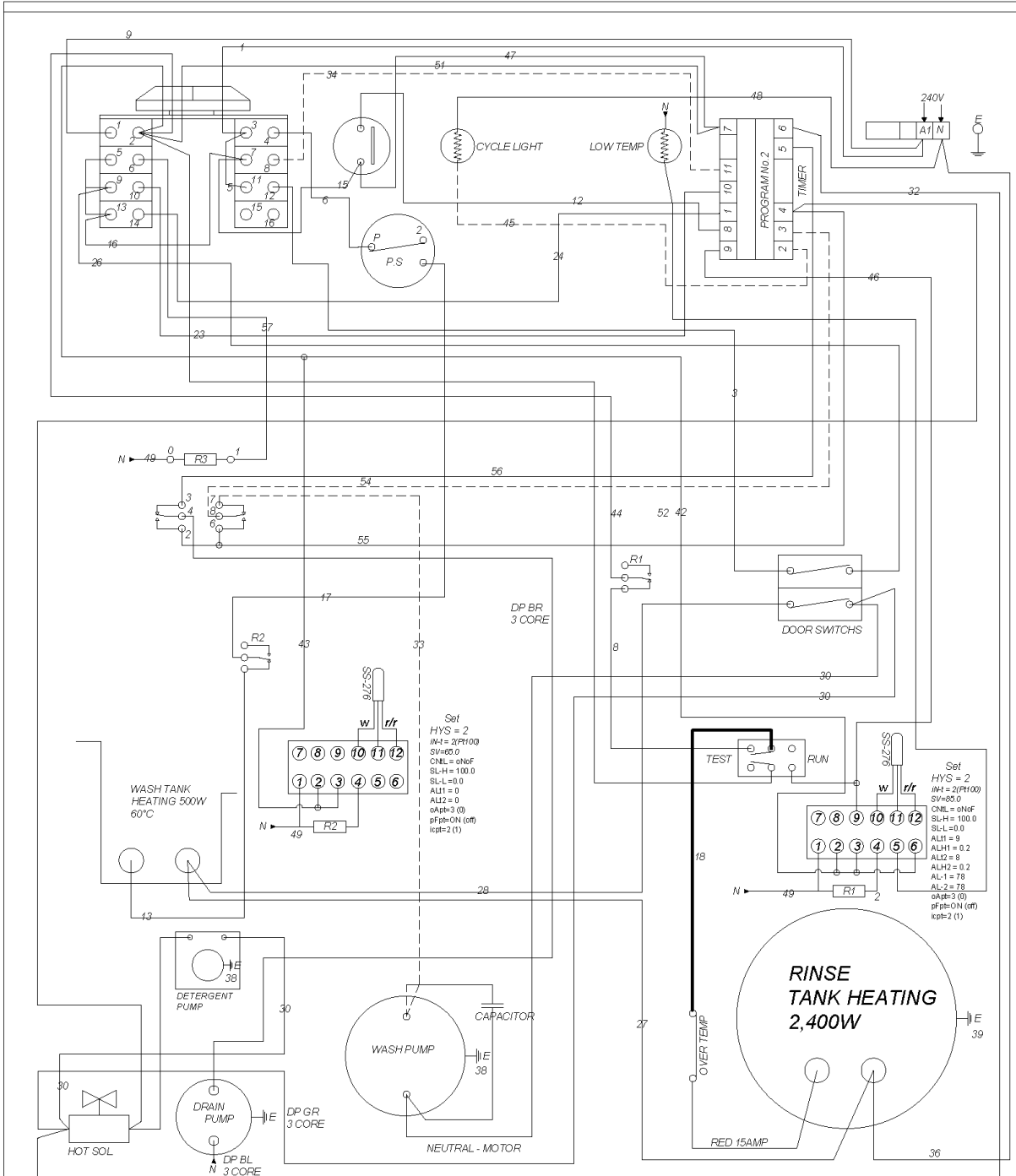

Rotary switch contacts

CONTACT	OFF	FILL	SHORT CYCLE	MID CYCLE	LONG CYCLE	DRAIN
1-2		X	X	X	X	X
3-4		X	X	X	X	
5-6		X				
7-8			X			
9-10				X		
11-12			X	X	X	X
13-14						X
15-16				X		

No	AMENDMENT	DATE	By	JIG No	Specific Instructions
①	RINSE PUMP	16.12.20	J.G		
				Sample No	

UCI-25N (with SS-270 & Omron TC)

### WIRING DIAGRAM

DATE	CHECKED	SCALE	DRAWING No
4.12.20			

ISSUE	01	DRAWN BY:	J.G	NTS	UC-25E05-4
-------	----	-----------	-----	-----	------------

TOLERANCES ON DIMENSIONS UNLESS OTHERWISE SPECIFIED  
WHOLE mm: ±0.5  
ANGULAR: ±1°

# Spare Parts

## 10. Spare Parts

### 10.1 Parts Diagram

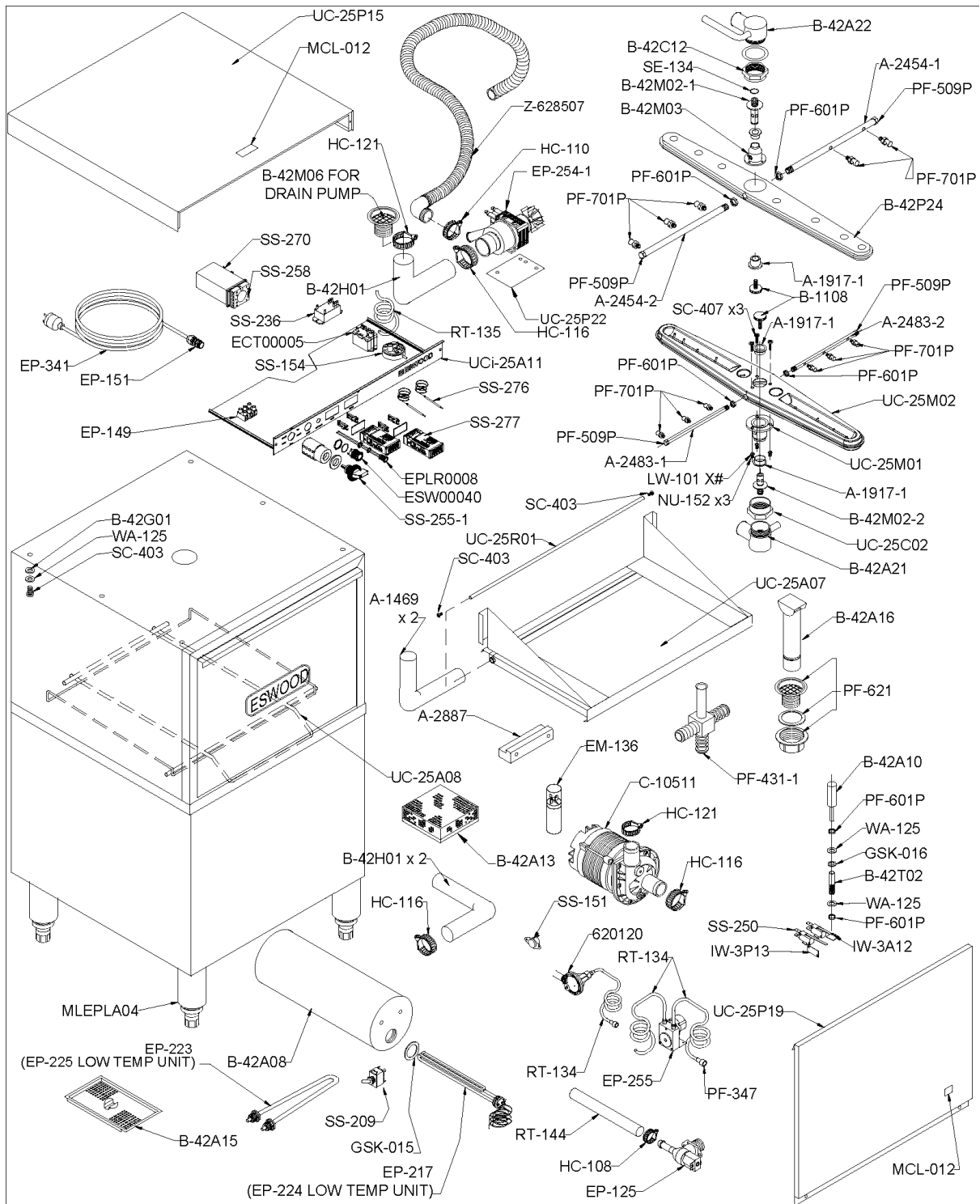

<h1>UCi-25N ESWOOD</h1>	REVISION: 01	CHANGE: S/N:	<h1>1</h1>
	ISSUE: 01		
	22.12.20		
	BY: J.G		
			6/11/07
			DRN: D.K

## 10.2 Parts List

<b>PART No.</b>	<b>DESCRIPTION</b>	<b>PART No.</b>	<b>DESCRIPTION</b>
620120	RINSE AID INJECTOR	GSK-016	GASKET
IW-3P13	INSTALLATION STRIP-MICRO SWITCH	HC-108	HOSE CLAMP SS
A-1917-1	BUSH RINSE ARM	HC-110	HOSE CLAMP SS 22-38
A-2454-1	RINSE ARM 2 JETS	HC-116	HOSE CLAMP SS 35-48
A-2454-2	RINSE ARM 3 JETS	HC-121	HOSE CLAMP SS 40-57
A-2483-1	RINSE ARM TUBE	IW-3A12	BRIDGE BRACKET ASSY
A-2483-2	RINSE ARM TUBE	MCL-012	WARNING LABEL – ELEC
A-2887	DOOR CATCH	PF-347	FILTER VALVE
B-1108	THRUST SCREW	PF-509P	CAP 3/8 X 26 TPI THD – BRASS
B-42A15	STRAINER ASSY	PF-601P	HEX BACK NUT 1/8" BSP BRASS
B-42A08	RINSE CYLINDER ASSY	PF-609P	1 1/2" HEX BACK NUT FLANGE
B-42A10	PLUNGER ASSY	PF-621	WASTE OUTLET – PLASTC COMP
B-42A13	FILTER INTAKE ASSY	PF-701P	RINSE JET ES-25
B-42A16	OVERFLOW TUBE ASSY	RT-134	TUBE 5MM I.D. CLEAR X 1M
B-42A21	LOWER DISCHARGE CASTING ASSY	RT-135	5MM RUBBER HOSE
B-42A22	UPPER DISCHARGE CASTING ASSY	RT-144	HOSE RUBBER 12MM – 1 M
B-42C12	NUT WASH ARM SUPPORT	SC-403	M5 X12MM PAN SCREW
B-42H01	PUMP INTAKE HOSE	SS-209	TOGGLE SWITCH DPDT
B-42M02-1	WASH ARM BEARING PIN	SS-151	OT SENSOR
B-42M02-2	BEARING PIN LOWER WASH	SS-154	PRESSURE SWITCH 50/15MM STD
B-42M03	WASH ARM BOSS	SS-236	240V RELAY AC COIL DPDT
B-42M06	1 1/2" BSP DRAIN FLANGE	SS-250	MICRO SWITCH 15A 43MM LEVER
B-42P24	WASH ARM ASSY	SS-255-1	ROTARY SWITCH + KNOB
B-42T02	BEARING TUBE PLUNGER	SS-276	TEMP CONTROLLER 3M PT100 3 WIRE
C-10511	WASH PUMP ASSY + CAPACITOR	SS-277	TEMP CONTROLLER WHITE PV DISPLAY
EM-136	CAPACITOR 12.5 UF	SS-270	ELECTRIC TIMER
EP-125	SOLENOID VALVE	SS-258	BASE TIMER
EPLR0008	12MM ROUND GREEN LED LIGHT	UC-25A07	DOOR ASSY
ESW00040	22MM LED MOMENTARY SWITCH	UC-25A08	RACK GUIDE ASSY
ECT00005	30A 1.5HP SP HD RELAY	UC-25C02	BOTTOM WASH SUPPORT NUT
EP-217	2400W RINSE CYLINDER ELEMENT	UC-25M01	FLANGER BEARING LOWER WASH ARM
EP-223	600W TANK ELEMENT	UC-25M02	WASH ARM
EP-254-1	DRAIN PUMP	UC-25P19	FRONT PANEL
EP-255	DETERGENT PUMP	UC-25R01	DOOR HINGE ROD
GSK-015	GASKET	WA-125	WASHER
		Z-628507	DRAIN HOSE

### 11. Warranty

#### **Goldstein Eswood Commercial Cooking Pty Ltd. Warranty Terms**

GOLDSTEIN ESWOOD COMMERCIAL COOKING PTY LTD. (hereafter "GECC") warrants that all products supplied by GECC (hereafter "product/s") are free of defects in material and workmanship for a period of 12 months from the date of purchase. Subject to the exclusions and conditions below, GECC undertakes to repair, replace, supply or refund (at GECC's option) all products and components supplied by GECC which GECC in its sole and absolute discretion deems to be defective in materials or workmanship under proper, normal and recommended conditions of use and maintenance.

This undertaking covers the provision of labour for 12 months and parts for 12 months from the date of purchase of the product.

Defective replacement spare parts will be repaired or re-supplied for a period of 3 months from delivery of the product.

Nothing in this warranty should be interpreted to extend any warranty received by, or benefiting, GECC to the customer. The terms of this warranty, and the obligations of GECC created by this warranty are as expressly stated in this warranty only. Any verbal representation made by GECC or third parties on behalf of GECC are not binding.

#### **Warranty Claim Procedure**

To obtain the benefit of this warranty, the customer must:

1. Give notice to GECC immediately upon becoming aware of the alleged defect and in any event before the expiration of the said 12 month period;
2. Provide GECC with proof of date of purchase; and
3. Stop using the product immediately, and switch it off until further instructions are provided by GECC.

Provided the warranty claim meets the requirements outlined in this document, GECC will provide service in support of the warranty claim. Part of this service will be the collection of information to diagnose the fault prior to arriving on site. Such information is to be provided to GECC by the customer in a prompt manner.

GECC will charge the customer for repairs (including labour, parts and travel) carried out by GECC or the GECC nominated service provider that are not covered by warranty and repairs that are not required to be carried out in terms of the Australian Consumer Law (if applicable). GECC will also charge for any items as listed under "Additional Charges" below. GECC will endeavour to quote for repairs prior to making the repair, including all applicable additional charges.

#### **Additional Charges**

GECC will charge the customer for the following Additional Charges:

- Service outside the normal working hours or on public holidays;
- Service outside of GECC's service area. This is 250km round trip from the closest GECC branch or the GECC nominated service provider;
- Additional costs of the warranty repair including but not limited to accommodation, cost of transport, site inductions and freight;
- Poor access and waiting time;
- All other costs including, without limitation, cartage, carriage and installation.

#### **Warranty Exclusions**

- The liability of GECC under this warranty is limited to the repair or replacement of defective products or components.
- This warranty does not cover normal or scheduled maintenance.
- This warranty does not cover consumable items including but not limited to globes, seals, drive belts, fuses, and water filters.
- This warranty does not cover the clearing of drains.
- This warranty does not cover the resetting of circuit breakers or overload devices.
- This warranty does not cover damage or malfunction to products resulting from poor maintenance or negligence of a party other than GECC.
- This warranty does not cover damage or malfunction to products caused intentionally or unintentionally by third parties, neglect or force majors.

*This warranty does not apply if a defect arises from any of the following:*

- *Improper installation or commissioning of the products.*
- *Installation of the products not performed by a licenced installer. Proof of licence number may be required by GECC at time of placing the warranty claim.*
- *Operation, use or maintenance of the product otherwise than in accordance with the instructions provided by GECC or any of the associated relevant Middleby Companies.*
- *Use of chemicals other than those recommended by GECC or any of the associated relevant Middleby Companies.*
- *Accidental damage, misuse, negligence or any other failure to take reasonable care.*
- *Use of the product for a purpose outside those specified by GECC or any of the associated relevant Middleby Companies.*
- *Use of the product for a purpose or in environmental conditions outside those specified by GECC or any of the associated relevant Middleby Companies.*
- *Where products have been disassembled or had unauthorised changes made by persons other than GECC or a GECC nominated service representative.*
- *Damage caused through blocked drains.*
- *Damage caused by blockages to pilots, injectors and burners.*
- *Damage arising from corrosion and/or lime scale.*
- *Damaged caused by, or the replacement of, parts or items not supplied by GECC or any of the associated relevant Middleby Companies.*
- *Damage caused by rodents or insects.*
- *Damage caused by lightning, flooding or an act of God.*

### **Warranty Conditions**

*This warranty is subject to the following conditions:*

- *Labour which is reasonable and necessary pursuant to the terms of this warranty is supplied free of charge during normal working hours, namely between 8:30am and 4:30pm Monday to Friday, excluding public holidays. Should warranty work be requested outside of normal working hours, charges will apply (see Additional Charges).*
- *While the products are in the custody of GECC for investigation or repair, they shall be at the risk of the customer and no liability shall attach to GECC, its servants or agents for any damage occasioned to, or loaned, the products howsoever arising.*
- *The warranty period is not renewed or extended as a result of a warranty repair or replacement unless by agreement with GECC.*
- *This warranty is not transferable and is only offered to the original customer.*
- *The warranty registration card was submitted on commissioning.*
- *This warranty only applies to products purchased from GECC or an authorised GECC distributor.*
- *Any warranty claim must meet the requirements set out in "Warranty Procedure".*
- *Warranty work must be performed only by GECC or by a GECC authorised service provider.*
- *When a product or component is replaced or refunded, any replaced item becomes the property of GECC.*
- *GECC may amend the terms of this warranty from time to time, at its absolute discretion.*